

CITY OF OAKLAND
AGENDA REPORT

OFFICE OF THE CITY CLERK
CITY OF OAKLAND
2007 MAR -13 PM 6:13

TO: Office of the City Administrator
ATTN: Deborah Edgerly
FROM: Public Works Agency
DATE: March 13, 2007

RE: **Resolution Authorizing Award Of A Contract To Bay Construction For The Rehabilitation Of Trestle Glen Stairs (Project No. C214810) For An Amount Not To Exceed Three Hundred Fifty-Three Thousand Nine Hundred Eighty Dollars (\$353,980.00)**

SUMMARY

A resolution has been prepared for Council to authorize award of a construction contract to Bay Construction in the amount of \$353,980.00 for the Rehabilitation of Trestle Glen Stairs project. The project is located in Council District 2.

Bay Construction is the responsible low bidder and has met all the contract requirements.

Funds are available for the contract work. This project is consistent with the Mayor and City Council Goal to Improve Oakland's Neighborhoods and to Maintain and Enhance Oakland's Physical Assets.

The project will rehabilitate the stairs and thereby improve pedestrian safety and mobility for the community.

Staff recommends approval of the resolution.

FISCAL IMPACTS

The Engineer's Estimate is \$338,331.00 and the low bid is \$353,980.00 provided by Bay Construction. The construction contract is in the amount of \$353,980.00, and the construction contingency is \$35,398.00 (10% of the contract amount). The project has sufficient funds to pay for the construction contract, contingency, design support, and construction management costs of the project. The City has all the existing funding of \$450,000.00 in the Rehabilitation of the Trestle Glen Stairs (Project No. C214820) Fund 2211, needed to complete this project. The source of the funding is from the Alameda County Transportation Improvement Authority (ACTIA).

Item: _____
Public Works Committee
March 13, 2007

BACKGROUND

The City of Oakland has approximately 272 paths and stairways. The demand is great for rehabilitating existing paths and stairways in Oakland. These paths and stairways are evaluated and prioritized based on the Council adopted prioritization criteria. These stairs have all been surveyed and ranked according to a variety of variables and assigned a numerical score. The variables include the condition of the stairs, proximity to transit and or schools, number of residents adjacent to the stairs and whether the stairs are currently useable. The Public Works Agency updates this ranking system every year and plans to conduct a more extensive survey this year.

This project is one of several planned projects to rehabilitate existing paths and stairways throughout Oakland. The Public Works Agency's annual budget for stairs repair is \$350,000 from Measure B funds. This covers roughly one project per year. The Trestle Glen stairs project was selected based on a longstanding commitment to the community.

Attachment C is the location of the two flights of stairs in the Trestle Glen neighborhood. Attachment D is the Citywide Inventory of Stairs and Paths.

On September 29, 2006, advertisement of the project to solicit bids was placed in the Oakland Tribune and San Francisco Chronicle newspapers, and Notices to Bidders were sent to all contractors holding an "A" License in the City's database and the Daily Pacific Builder.

On October 23, 2006, the City Clerk received and opened three bids for the project as shown in the table below. Bid discounts of 5% for Local Business Enterprise and Small Local Business Enterprise (SLBE/SLBE) participation were applied to these bids. Bid details are presented in the Contract Compliance memo of Attachment A. Bay Construction had both the lowest project bid as well as the lowest bid that incorporated bid discounts. Thus Bay Construction, the lowest responsible bidder, is recommended for contract award with a bid price of \$353,980.00.

Bidders	Total LBE/SLBE Participation	Location	Bid Amount
Bay Construction	92.60%	Oakland, CA	\$353,980.00
Ray's Electric	90.19%	Oakland, CA	\$358,654.00
Beliveau Engineering	97.25%	Oakland, CA	\$396,768.00

Compliance with City Programs: Bay Construction is in full compliance with City goals for Local and Small Local Business Enterprises. Under the proposed contract, Bay Construction exceeds the City's 20% LBE/SLBE requirement. The bid documents show Local Trucking participation of 100%.

KEY ISSUES AND IMPACTS

Construction is scheduled to begin in middle of March 2007 and should be completed by June 2007. The project schedule is contained in Attachment B. The contract specifies \$750.00 in liquidated damages per calendar day if the contractor exceeds the contract completion time of 55 working days.

Staff has reviewed the submitted bids for this work and determined that the lowest bid is reasonable.

PROJECT DESCRIPTION

In general, the proposed work consists of the reconstruction of an existing public stairway with timber and concrete stairs, handrails, new concrete pathway and sidewalk, fences, concrete and stone walls.

SUSTAINABLE OPPORTUNITIES

Economic: Over 90% of the work is performed by Oakland residents, thus providing jobs, and improving the local economy. The project will also improve pedestrian safety and enhance the general aesthetics of community with new and improved stairs, concrete pathway and sidewalk.

Environmental: Air quality will be improved to the extent that the new stairs encourage pedestrian traffic and circulation in the community. The contractor will be required to make every effort to reuse clean fill materials and use recyclable concrete and asphalt products.

Social Equity: The stairs, handrails and pedestrian access suffered from general deterioration, which decreased the level of safety and access to pedestrians. The new and improved stairways with handrails, paved pathway and sidewalk will provide pedestrian accessibility, and safer, more livable and cleaner pedestrian areas at Trestle Glen Road, Bowles Place and Van Sicklen Place.

DISABILITY AND SENIOR CITIZEN ACCESS

The project will construct new paved pathways, sidewalks and stairs that meet the Federal Americans with Disabilities Act. The Trestle Glen area will be more accessible and safer for all citizens, especially senior citizens and persons with disabilities.

RECOMMENDATION AND RATIONALE

It is recommended that the construction contract be awarded to Bay Construction, the lowest responsible bidder, in an amount not to exceed \$353,980.00 for constructing the Rehabilitation of Trestle Glen Stairs (Project No. C214810).

The contractor, Bay Construction, has met the LBE/SLBE requirements and there are sufficient funds in the project account.

ACTION REQUESTED OF THE CITY COUNCIL

Staff recommends that the City Council approve the resolution.

Respectfully submitted,

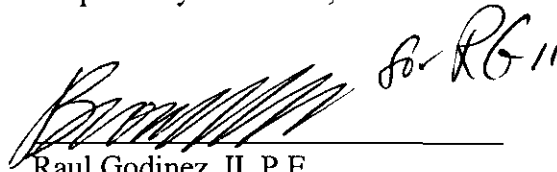

Raul Godinez, II, P.E.

Director, Public Works Agency

Reviewed by:
Michael Neary, P.E.
Assistant Director, Public Works Agency

Prepared by:
Emad Mirsaeidi, P.E.
Supervising Civil Engineer
Engineering Design Division

APPROVED AND FORWARDED TO THE
PUBLIC WORKS COMMITTEE:

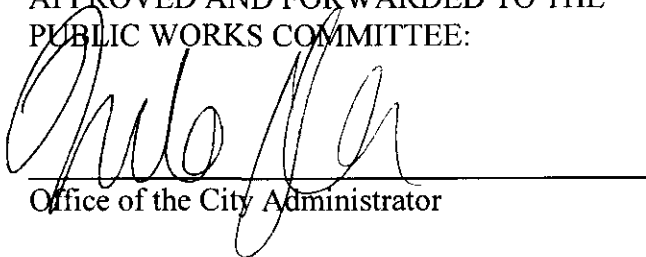

Office of the City Administrator

Item: _____
Public Works Committee
March 13, 2007

Attachment A

**Contract Compliance Review
Rehabilitation of Trestle Glen Stairs**

(Project No. C214820)

RECEIVED
2006 NOV 10 PM 3:19



Memo

Office of the City Administrator
Contract Compliance & Employment Services Division

To: Gwen McCormick
From: Vivian Inman, Contract Compliance Officer, CC&ES Division
Through: Deborah Barnes
CC: Eric Uddenberg
Date: November 10, 2006
Re: Compliance Analysis: Rehabilitation of Trestle Glen Stairs

Contract Compliance & Employment Services reviewed three (3) bids received in response to the above referenced project. Below is the outcome of our compliance evaluation for the twenty percent (20%) minimum participation requirement and a preliminary review for compliance with the Equal Benefits Ordinance.

The L/SLBE findings are as follows:

	Company Name	Bid Amount (If Applicable)	Proposed Participation				Preferences			Banked Credits Eligibility?	EBO Compliant? (Y/N)
			Total L/SLBE	LBE	SLBE	Trucking	Total Credited	Adjusted Bid Amount	Points		
1	Bay Construction	\$353,980	92.60%	0%	92.60%	100%	92.60%	\$336,281	5%	2	Y
2	Ray's Electric	\$358,654	90.19%	0%	90.19%	100%	90.19%	\$340,721	5%	2	Y
3	Beliveau Engineering	\$396,768	97.25%	0%	97.25%	100%	97.25%	\$376,929	5%	2	Y

As noted above all contractors exceeded the minimum 20% requirement and are EBO compliant.

If you have questions or need additional information, please contact Vivian Inman, Contract Compliance Officer, at 238-6261.

CONTRACT COMPLIANCE & EMPLOYMENT SERVICES
PROJECT EVALUATION FORM

PROJECT NO. C214820

PROJECT NAME Rehabilitation of Trestle Glen Stairs

CONTRACTOR: Bay Construction

<u>Engineer's Estimate:</u>	<u>Contractors' Bid Amount</u>	<u>Over/Under Engineer's Estimate</u>
\$338,331.00	\$353,980.00	-\$15,649.00

<u>Bid discounted amount:</u>	<u>Discount Points:</u>
\$336,281.00	5%

1. Did the 20% requirements apply? YES

2. Did the contractor meet the 20% requirement YES

a) % of LBE participation 0.00%

b) % of SLBE participation 92.60%

3. Did the contractor meet the Trucking requirement? YES

a) Total trucking participation 100.00%

4. Did the contractor receive bid discount points? YES

(If yes, list the points received) 5%

5. Additional Comments.

Bay Construction did not complete the Schedule R in its entirety, failed to list ethnicity, and gender.

6. Date evaluation completed and returned to Contract Admin./Initiating Dept.

11/10/2006

Date

Reviewing Officer:



Date: 11/18/06

Approved By

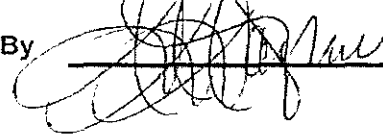

Date: 11/10/06

LBE/SLBE Participation Bay Construction

Project Name: Rehabilitation of Trestle Glen Stairs

Project No.: C214820		Engineers Est: 338,331.00				Under/Over Engineers Estimate: -15,649.00							
Discipline	Prime & Subs	Location	Cert. Status	LBE	SLBE	Total LBE/SLBE	S/LBE Trucking	Total Trucking	TOTAL Dollars	For Tracking Only			
										Ethn.	MBE	WBE	
PRIME	Bay Construction	Oakland	CB		\$323,780.00	\$323,780.00			\$323,780.00	A	\$323,780.00		
Drilling	Ofiaro Builders	Richmond	UB						\$4,320.00	NL			
Steel	A. Hilboru	Santa Rosa	UB						\$10,880.00	NL			
Trucking	Williams Trucking	Oakland	CB		\$4,000.00	\$4,000.00	\$4,000.00	\$4,000.00	\$4,000.00	AA	\$4,000.00		
Lumber	Economy Lunber	Oakland	UB						\$11,000.00	C			
Project Totals				\$0.00	\$327,780.00	\$327,780.00	\$4,000.00	\$4,000.00	\$353,980.00		\$327,780.00	\$0.00	
				0.00%	92.60%	92.60%	0.00%	100.00%	100.00%		92.60%		
Requirements: The 20% requirements is a combination of 10% LBE and 10% SLBE participation. An SLBE firm can be counted 100% towards achieving 20% requirements.				LBE 10%	SLBE 10%	TRUCKING 20%	LBE/SLBE 20%		Ethnicity AA = African American A = Asian C = Caucasian H = Hispanic NA = Native American O = Other NL = Not Listed				
Legend				LBE = Local Business Enterprise		SLBE = Small Local Business Enterprise		Total LBE/SLBE = All Certified Local and Small Local Businesses		NPLBE = NonProfit Local Business Enterprise		NPSLBE = NonProfit Small Local Business Enterprise	
				UB = Uncertified Business		CB = Certified Business		MBE = Minority Business Enterprise		WBE = Women Business Enterprise			

CONTRACT COMPLIANCE & EMPLOYMENT SERVICES
PROJECT EVALUATION FORM

PROJECT NO. C214820

PROJECT NAME Rehabilitation of Trestle Glen. Stairs

CONTRACTOR: Ray's Electric

<u>Engineer's Estimate:</u>	<u>Contractors' Bid Amount</u>	<u>Over/Under Engineer's Estimate</u>
\$338,331.00	\$358,654.00	\$ (20,323.00)

<u>Bid discounted amount:</u>	<u>Discount Points:</u>
\$340,721.00	2%

1. Did the 20% requirements apply? YES

2. Did the contractor meet the 20% requirement? YES

a) % of LBE participation 0.00%

b) % of SLBE participation 90.19%

3. Did the contractor meet the Trucking requirement? YES

a) Total trucking participation 100.00%

4. Did the contractor receive bid discount points? YES

(If yes, list the points received) 5%

5. Additional Comments.

6. Date evaluation completed and returned to Contract Admin./Initiating Dept.

11/10/2006

Date

Reviewing
Officer:

Date: 11/10/06

Approved By

Date: 11/10/06

LBE/SLBE Participation Ray's Electric

Project Name: Rehabilitation of Trestle Glen Stairs

Project No.: C214820		Engineers Est: 338,331.00				Under/Over Engineers Estimate: -20,323.00						
Discipline	Prime & Subs	Location	Cert. Status	LBE	SLBE	Total LBE/SLBE	S/LBE Trucking	Total Trucking	TOTAL Dollars	For Tracking Only		
										Ethn.	MBE	WBE
PRIME	Ray's Electric	Oakland	CB		\$320,474.00	\$320,474.00			\$320,474.00	C		
Concrete	Central Concrete	Oakland	UB						\$8,800.00	C		
Railing	A.H.L. Born	Santa Rosa	UB						\$10,880.00	C		
Trucking	Williams Trucking	Oakland	CB		\$3,000.00	\$3,000.00	\$3,000.00	\$3,000.00	\$3,000.00	AA	\$3,000.00	
Lumber	Economy Lumber	Oakland	UB						\$15,500.00	NL		
Project Totals				\$0.00	\$323,474.00	\$323,474.00	\$3,000.00	\$3,000.00	\$358,654.00		\$3,000.00	\$0.00
				0.00%	90.19%	90.19%	100.00%	100.00%	100.00%		0.84%	
Requirements: The 20% requirements is a combination of 10% LBE and 10% SLBE participation. An SLBE firm can be counted 100% towards achieving 20% requirements.				LBE 10%	SLBE 10%	TRUCKING 20%	LBE/SLBE 20%			Ethnicity AA = African American A = Asian C = Caucasian H = Hispanic NA = Native American O = Other NL = Not Listed		
Legend				LBE = Local Business Enterprise				UB = Uncertified Business				
				SLBE = Small Local Business Enterprise				CB = Certified Business				
				Total LBE/SLBE = All Certified Local and Small Local Businesses				MBE = Minority Business Enterprise				
				NPLBE = NonProfit Local Business Enterprise				WBE = Women Business Enterprise				
				NPSLBE = NonProfit Small Local Business Enterprise								

*The dollar amount listed for Williams Trucking represented less than 1/2% of the proposed contract amount. Per the California Public Contract Code Sections 4100 et seq. contractors are required to only list the name and location of the place of business of each subcontractor who will perform more than 1/2% of the work or labor based on the estimated cost elements of the proposal.

CONTRACT COMPLIANCE & EMPLOYMENT SERVICES
PROJECT EVALUATION FORM

PROJECT NO. C214820

PROJECT NAME Rehabilitation of Trestle Glen Stairs

CONTRACTOR: Beliveau Engineering

<u>Engineer's Estimate:</u>	<u>Contractors' Bid Amount</u>	<u>Over/Under Engineer's Estimate</u>
\$338,331.00	\$396,768.00	-58,437.00

<u>Bid discounted amount:</u>	<u>Discount Points:</u>
\$376,929.00	5%

1. Did the 20% requirements apply? YES

2. Did the contractor meet the 20% requirement YES

a) % of LBE participation 0.00%

b) % of SLBE participation 97.25%

3. Did the contractor meet the Trucking requirement? YES

a) Total trucking participation 100.00%

4. Did the contractor receive bid discount points? YES

(If yes, list the points received) 5%

5. Additional Comments.

6. Date evaluation completed and returned to Contract Admin./Initiating Dept.

11/10/2006

Date

Reviewing
Officer:

Date: 11/10/06

Approved By

Date: 11/10/06

LBE/SLBE Participation Beliveau Engineering

Project Name: Rehabilitation of Trestle Glen Stairs

Project No.: C214820		Engineers Est: 338,331.00				Under/Over Engineers Estimate: -58,437.00						
Discipline	Prime & Subs	Location	Cert. Status	LBE	SLBE	Total	S/LBE	Total	TOTAL	For Tracking Only		
						LBE/SLBE	Trucking	Trucking	Dollars	Ethn.	MBE	WBE
PRIME	Beliveau Engineering	Oakland	CB		\$380,268.00	\$380,268.00			\$380,268.00	C		
Metals	Ahlburn Steel	Santa Rosa	UB						\$10,900.00	C		
Trucking	Williams Trucking	Oakland	CB		\$5,600.00	\$5,600.00	\$5,600.00	\$5,600.00	\$5,600.00	AA	\$5,600.00	
Project Totals				\$0.00	\$385,868.00	\$385,868.00	\$5,600.00	\$5,600.00	\$396,768.00		\$5,600.00	\$0.00
				0.00%	97.25%	97.25%	0.00%	100.00%	100.00%		1.41%	
Requirements: The 20% requirements is a combination of 10% LBE and 10% SLBE participation. An SLBE firm can be counted 100% towards achieving 20% requirements.				LBE 10%	SLBE 10%	TRUCKING 20%	LBE/SLBE 20%		Ethnicity AA = African American A = Asian C = Caucasian H = Hispanic NA = Native American O = Other NL = Not Listed			
Legend				LBE = Local Business Enterprise		UB = Uncertified Business						
				SLBE = Small Local Business Enterprise		CB = Certified Business						
				Total LBE/SLBE = All Certified Local and Small Local Businesses		MBE = Minority Business Enterprise						
				NPLBE = NonProfit Local Business Enterprise		WBE = Women Business Enterprise						
				NPSLBE = NonProfit Small Local Business Enterprise								

Attachment C

Location Map

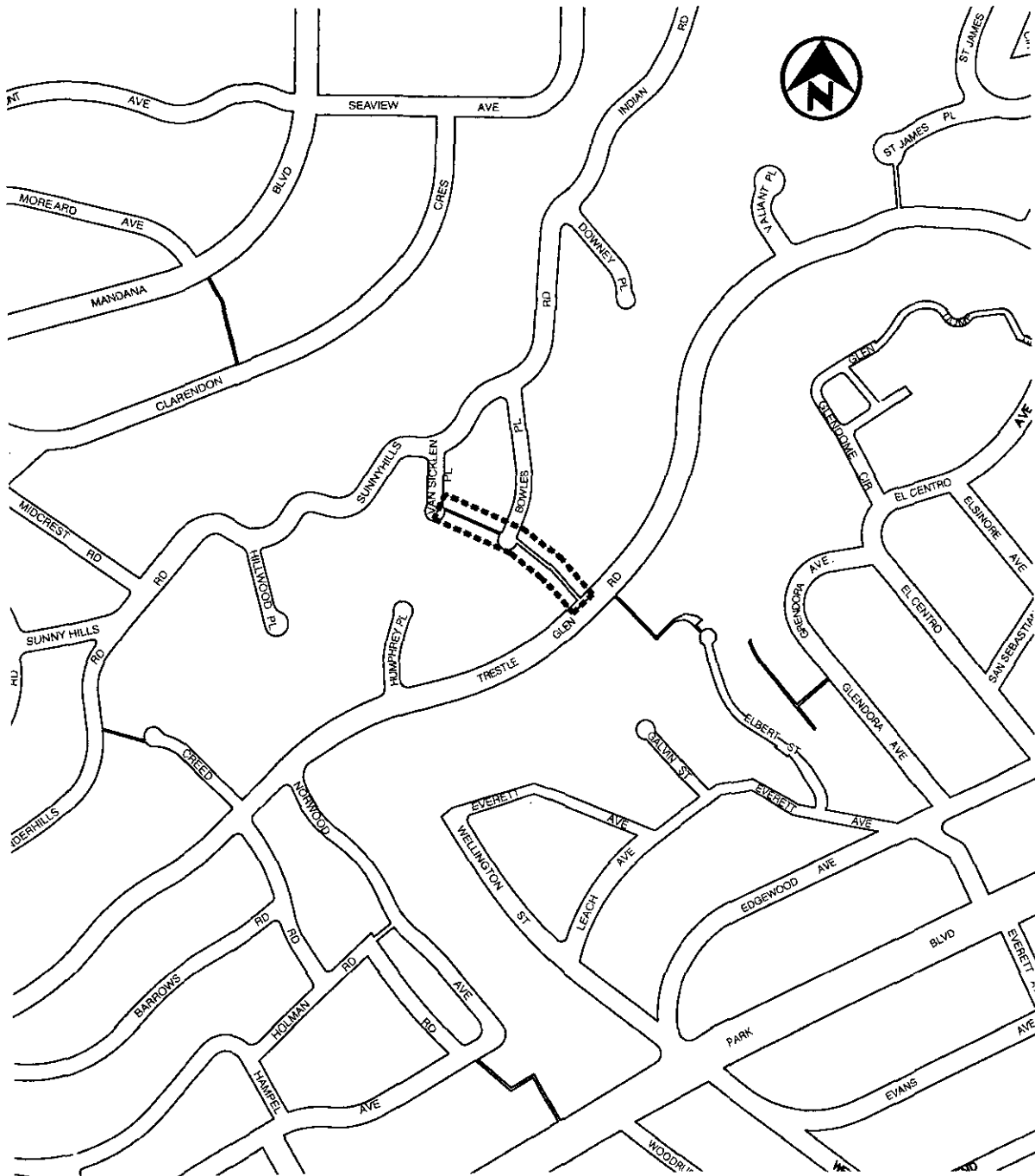

CITYWIDE INVENTORY OF STAIRS AND PATHS

ATTACHMENT D

walkway #	From	To	Name	Length	Width	Public/Private (P/P)	Passable/Impassable (P/I)	Stairs (Y/N/#)	Hand rail (Y/N)	Materials (concrete, asphalt, dirt, wood, gravel)	Signs (#)	Light (Y/N/#)	Residences or Buildings (#)	Near School (Y/N)	Near Transit (Y/N)	Slope (none, moderate, steep)	Plants (light, moderate, heavy)	Condition (good, OK, bad)	Total
18	1893 Magellan	Cortereal (dead end)		300	4	B	I	0	N	D	0	0	2	Y	Y	M	H	B	10
28	6624 Simson	6625 Mokelumne		300	10	B	I	0	N	DA	0	0	4	Y	Y	M	M	B	10
33	3151 Courtland	3150 High St.		350	6	P	I	0	N	D	0	Y	20	N	Y	N	L	B	10
120	14 Wyman	MacArthur at Richards Rd.		300	10	B	I	9	N	WD	0	0	3	Y	Y	S	H	B	10
153	8901 Seneca	8900 Burr		375	5	B	I	90	Y	CAWD	0	0	4	Y	Y	S	H	B	10
185	Armour Dr (N)	S) Armour Dr.		300	3	B	I	0	N	D	0	0	1	Y	Y	S	H	B	10
213	Sausal Ck Trl	Highway 13 Tunnel		1400	6	B	N	0	N	D/C	0	0	7	Y	Y	N	M	B	10
262	Courtland at Fairfax	Courtland at Brookdale		550	10	B	P	0	N	AD	0	5	20	Y	Y	N	M	OK	9
16	1844 Magellan	Gaspar (dead end)		300	4	B	P	187	Y	C	0	0	4	Y	Y	S	L	G	8
22	3601 73rd	7209 Sunkist	Mayfield Path	400	10	B	P	13	Y	ADW	1	Y	6	Y	Y	S	M	B	8
100	3101 Park Blvd	33 Home Place		200	10	B	I	Y	Y	CA	0	0	17	Y	Y	M	M	G	8
124	driveway of 1716 Gouldin	6067 Aspinwall		300	4	B	P	0	N	D	0	0	3	Y	Y	M	M	B	8
151	7873 Greenly	7886 Sterling		250	10	B	I	0	N	D	0	0	4	Y	Y	S	M	B	8
152	7887 Sterling	7920 Crest		300	10	B	I	0	N	D	0	0	4	Y	Y	S	M	B	8
175	200' below Hermosa on Broadway Terrace	50 Mandalay		200	2	B	I	0	N	D	0	0	1	Y	Y	S	M	B	8
184	Alhambra Ln at Thornhill Elementary	1715 Alhambra Ln		250	3	B	I	0	N	D	0	0	3	Y	Y	S	H	B	8
260	Courtland at Tyrell	Courtland at Congress		325	5	B	P	0	N	G	0	0	20	Y	Y	N	L	G	8
271	1651 Fruitvale Ave	2879 E 17th St		500	8	B	P	0	N	DC	0	many	50	Y	Y	N	L	G	8
23	7500 Hillmont	7501 Sunkist		400	10	B	P	0	N	D	0	0	4	Y	Y	S	M	OK	7
41	2102 Harrington	2141 Ransom	Carrington Way	250	5	B	P	73	Y	C	2	Y	5	Y	Y	S	M	B	7
67	2600 School	2906 McKillop		500	5	B	P	0	Y	A	0	0	3	Y	Y	S	M	OK	7
154	8500 Thermal	8522 MacArthur		450	6	B	P	184	Y	C	0	2	8	Y	Y	S	L	OK	7
211	Florence & Merriewood	5733 Grisborne Ave.		175	3	B	I	0	N	D	0	0	5	Y	Y	M	M	B	7
229	780 Carlton	910 Paramount		200	5	B	I	101	N	C	0	0	3	Y	Y	S	H	OK	7
261	Courtland at Congress	Courtland at Fairfax		200	5	B	P	0	N	AG	0	0	15	Y	Y	M	L	OK	7
263	3186 McKillop	2600 School		500	4	B	P	43	Y	A	0	0	2	Y	Y	M	L	OK	7
27	7835 Outlook	2920 Parker		400	5	B	I	0	N	D	0	0	4	N	Y	M	L	B	6
63	4168 Greenwood	4187 Park Blvd		500	5	B	P	83	Y	C	0	4	30	N	Y	M	L	G	6
74	538 Mira Vista	564 Valle Vista	Bonham Way	400	5	B	P	20	N	C	1	0	6	Y	Y	M	M	G	6
105	1747 22nd Ave	1740 21st Ave		200	6	B	P	0	N	DA	0	Y	4	Y	Y	M	H	B	6
127	7007 Broadway Terrace	151 Taurus		200	3	B	I	35	Y	DW	0	0	4	N	Y	M	M	B	6
128	Virgo (dead end)	Taurus (dead end)		500	2	?	I	0	N	D	0	0	2	N	N	M	M	B	6
146	6261 Broadway Terrace	155 Florence	Ratondo Path	250	6	B	I	0	N	DC	1	0	4	Y	Y	S	M	B	6
183	6025 Bruns	Montclair Park	Brns Overcrossing	300	6	B	P	65	Y	C	0	5	1	Y	Y	M	L	G	6
208	1837 Indian	25 Overlake Ct.		250	4	B	P	107	N	AW	0	1	5	Y	Y	M	N	OK	6
219	3331 E 8th St	E. 9th St. & 34th Ave.		100	5	B	P	0	N	C	0	0	0	Y	Y	N	L	B	6
258	Courtland at Thompson	Courtland at San Carlos		250	10	B	P	0	N	G	0	0	20	Y	Y	N	L	G	6
259	Courtland at San Carlos	Courtland at Tyrell		250	6	B	P	0	N	G	0	0	20	Y	Y	M	L	G	6

CITYWIDE INVENTORY OF STAIRS AND PATHS

ATTACHMENT D

Walkway #	From	To	Name	Length	Width	Public/Private (B/P)	Passable/Impassable (P/I)	Stairs (Y/N/#)	Hand rail (Y/N)	Materials (concrete, asphalt, dirt, wood, gravel)	Signs (#)	Light (Y/N/#)	Residences or Buildings (#)	Near School (Y/N)	Near Transit (Y/N)	Slope (none, moderate, steep)	Plants (light, moderate, heavy)	Condition (good, OK, bad)	Total
270	1809 37th Ave	3705 Foothill Blvd		500	8	B	P	0	N	A	0	5	50	N	Y	N	L	G	6
8	2646 Camino Lenada	2700 Las Aromas		320	6	B	P	16	Y	AS	0	0	4	Y	N	S	L	OK	5
21	2220 Braemar	driveway of Beehive Center (2735 Monterey)		300	3	B	P	52	Y	DWC	0	0	3	N	Y	S	M	OK	5
38	2198 42nd	2185 High	San Carlos Walk	250	5	B	P	8	Y	C	2	0	4	Y	Y	M	M	OK	5
39	2190 41st	2195 42nd		250	5	B	P	26	Y	C	0	0	5	Y	Y	N	M	OK	5
84	6132 Margarido	Freeway @ Broadway		150	6	B	P	111	Y	C	0	0	0	Y	Y	N	M	OK	5
87	6141 Ocean View	6000 Manchester	West Lane	320	8	B	P	31	Y	C	2	0	2	N	Y	S	L	OK	5
111	2350 E. 22nd	2216 Inyo		100	6	B	P	Y	N	C	0	0	3	Y	Y	M	M	OK	5
112	2777 21st	2784 Foothill		175	6	B	P	0	N	C	0	Y	5	Y	Y	N	L	OK	5
117	261, 269 Fairmont Terrace	3000 Richmond Ave.		250	5	B	P	76	Y	C	0	4	50	N	Y	M	M	OK	5
199	1096 Clarendon	1099 Mandana		200	5	B	P	7	Y	C	0	0	4	Y	Y	M	M	OK	5
200	1116 Longridge	32 Mandana Circle		250	5	B	P	41	N	C	0	0	4	Y	Y	M	M	OK	5
210	5901 Marden Ln	5925 Thornhill		100	4	B	P	72	Y	WA	0	0	4	Y	Y	M	N	OK	5
215	Morpeth & Harbor	30 Mandalay (backside of St. Theresa Church)		250	10	B	P	0	N	A	0	0	8	Y	Y	M	L	G	5
216	10th & Alice	11th and Alice		200	6	B	P	0	N	A	0	0	0	Y	Y	N	L	OK	5
218	849 Walavista	walkway 55		800	5	B	P	0	N	CAD	0	Y	20	N	N	N	M	OK	5
227	middle of Eucalyptus Path	middle of Willow Walk	Sunset Trail	900	4	B	P	0	N	A	1	0	20	N	N	N	L	OK	5
269	1809 37th Ave	1831 38th Ave		250	8	B	P	0	N	AW	0	1	10	N	Y	N	L	OK	5
12	15 Diaz Pl.	5680 Cabot		200	4	B	P	98	Y	C	0	0	4	Y	Y	M	L	G	4
13	1670 Mountain	5707 Cabot		250	4	B	P	180	Y	C	0	0	3	Y	Y	M	M	OK	4
17	5600 Colton	1833 Magellan		250	4	B	P	143	Y	C	0	0	4	Y	Y	S	L	G	4
25	7864 Hillmont	7879 Michigan		300	8	B	I	0	N	D	0	0	4	N	N	M	H	B	4
30	2848 Seminary	2851 60th		225	6	B	P	0	N	C	1	0	4	Y	Y	N	L	G	4
37	4445 Tompkins	4456 Hyacinth		175	5	B	P	0	N	C	0	0	4	Y	Y	N	M	G	4
45	1921 Oakview	1745 Leimert		200	5	B	P	93	N	AW	0	0	4	N	Y	S	L	B	4
51	1075 Glendora	dead end walkway	Glendora Path	325	4	B	P	3	N	C	1	0	10	N	N	M	M	G	4
56	1000 Longridge	853 Paramount		200	5	B	P	10	N	C	0	0	4	Y	Y	M	M	G	4
61	500 Rosemount	872 Northvale		300	5	B	P	22	N	C	0	0	4	Y	N	M	M	G	4
62	1329 Barrows	1332 Holman		300	5	B	P	78	Y	CWA	0	0	4	N	Y	S	H	G	4
64	1443 E 36th	1442 MacArthur		200	5	B	P	16	Y	CA	0	1	5	Y	Y	M	M	G	4
66	3020 Sheffield	3021 McKillop		150	3	B	P	0	N	AD	0	0	3	Y	N	M	H	B	4
73	564 Valle Vista	3629 Grand	Bonham Way	250	5	B	P	Y	N	C	1	0	6	Y	Y	M	M	G	4
81	Broadway at College	318 Hemphill		100	10	B	P	0	N	C	0	Y	1	Y	Y	N	M	G	4
97	5766 Claremont	5651 Oak Grove	Pedestrian Way	300	7	B	P	0	N	C	2	Y	4	N	Y	N	M	G	4
102	2505 Wallace		E. 25th St. Way	150	6	B	P	5	N	C	2	0	10	N	Y	M	L	G	4
115	Harrison, across from Westlake Middle School	171 Vernon Terrace		250	5	B	P	56	Y	C	0	2	4	Y	Y	S	M	G	4
116	128 Hamilton	251 28th St.		250	4	B	P	86	Y	C	0	Y	100+	N	Y	S	L	G	4
145	6370 Broadway Terrace	6353 Contra Costa	Erba Path	295	5	B	P	80	Y	C	2	0	0	Y	Y	M	L	G	4

CITYWIDE INVENTORY OF STAIRS AND PATHS

ATTACHMENT D

Walkway #	From	To	Name	Length	Width	Public/Private (B/P)	Passable/Impassable (P/I)	Stairs (Y/N/#)	Hand rail (Y/N)	Materials (concrete, asphalt, dirt, wood, gravel)	Signs (#)	Light (Y/N/#)	Residences or Buildings (#)	Near School (Y/N)	Near Transit (Y/N)	Slope (none, moderate, steep)	Plants (light, moderate, heavy)	Condition (good, OK, bad)	Total
155	3239 Blandon	9110 Fontaine		160	5	B	P	0	N	C	0	0	4	Y	Y	N	M	G	4
168	485 Hardy St.	482 Clifton St.		600	6	B	P	0	N	AC	0	0	25	N	Y	N	M	G	4
172	6142 Ocean View	6245 Brookside Ave	Claremont Path	250	6	B	P	65	Y	C	2	0	4	Y	Y	M	M	G	4
173	5600 Golden Gate Ave.	5747 Buena Vista Rd.	Arolo Path	140	6	B	P	64	Y	C	2	0	4	Y	Y	S	L	G	4
197	5945 Zinn	Drake/Asilomar		200	3	B	I	33	N	DW	0	0	4	N	Y	M	M	B	4
207	7867 Sunkist	7872 Michigan		300	6	B	I	Y	Y	DW	0	0	4	N	N	M	M	B	4
209	5607 Merriewood	5901 Marden Ln		100	4	B	P	110	Y	WA	0	1	4	Y	Y	M	N	G	4
230	walkway 2020	619 Paloma		1700	10	B	P	0	N	D	0	0	30	N	N	N	L	G	4
233	1900 Mountain	Cortereal (dead end)		300	6	B	P	15	Y	CDA	0	0	1	Y	Y	M	L	G	4
236	Swan's Market	Swan's Market		200	10	V	P	0	N	C	0	Y	25	N	Y	N	L	G	4
244	Lakeshore Ave	Merritt Ave at Cleveland St	Cleveland Cascade	250	8	B	P	135	Y	C	1	0	40	N	Y	S	M	G	4
246	walkway 419	111 Fairmount (into church parking lot)		150	5	B	P	43	Y	CW	0	0	100+	N	Y	M	L	G	4
253	Alice at Embarcadero W	Amtrak Station		150	10	V	P	120	Y	C	0	Y	100+	N	Y	N	L	G	4
267	3448 Davis St	2537 34th Ave		300	5	B	P	0	Y	A	0	0	10	N	N	N	L	G	4
268	1806 38th Ave	39th Ave @ E 18th St		225	6	B	P	0	N	C	0	3	10	N	Y	N	L	G	4
5	6259 Clive	2751 Darby		200	3	B	P	11	N	CA	0	0	4	N	Y	M	L	OK	3
7	2700 Las Aromas	2701 Mountain Gate @ Castle		245	6	B	P	8	N	A	0	0	4	Y	N	S	L	OK	3
44	3579 Wilson	2511 Damuth		200	5	B	P	7	N	AC	0	0	4	N	Y	N	M	OK	3
46	1774 Leimert	4350 Bridgeview	Bridgeview Path	250	5	B	P	87	N	C	0	0	4	N	Y	S	M	OK	3
52	1601 Trestle Glen	1000 Elbert		400	3	B	P	42	Y	C	0	1	3	N	N	M	M	OK	3
69	2745 25th	2397 Grande Vista Pl.		150	5	B	P	15	Y	C	0	0	8	Y	N	M	M	G	3
78	4507 Pleasant Valley Ct. N.	4468 Piedmont		230	8	B	P	13	Y	CW	0	0	0	N	Y	M	L	OK	3
79	4486 Pleasant Valley Ct. S.	4507 Pleasant Valley Ct. N.		185	8	B	P	0	N	C	0	0	0	N	Y	N	L	OK	3
85	6128 Rockridge Blvd S	5972 Margarido	Prospect Steps	350	6	B	P	47	N	C	2	0	4	N	N	M	M	OK	3
86	5972 Margarido	5975 Manchester	Prospect Steps	165	6	B	P	76	N	C	2	0	4	N	Y	M	M	OK	3
88	5361 Margarido	6101 Rockridge Blvd. S.		270	5	B	P	56	N	C	0	0	4	N	Y	M	M	OK	3
101	2622 14th Ave	2573 Wallace	E. 26th St. Way	150	6	B	P	61	Y	C	2	0	8	N	Y	M	M	G	3
137	73 Alvarado	Claremont Hotel parking lot		250	6	B	P	45	N	CAS	0	0	1	N	Y	S	M	OK	3
139	6000 Buena Vista	5232 Golden Gate	Chaumont Path	275	6	B	P	48	N	C	2	0	4	N	Y	M	M	OK	3
140	5991 Contra Costa	6000 Buena Vista	Chaumont Path	220	6	B	P	76	N	C	2	0	4	N	Y	M	M	OK	3
141	5176 Golden Gate	6105 Buena Vista	Belalp Path	250	6	B	P	58	Y	C	2	0	2	N	Y	M	H	OK	3
142	6105 Buena Vista	6100 Contra Costa	Belalp Path	160	6	B	P	71	Y	C	2	0	4	N	Y	M	M	OK	3
143	6190 Buena Vista	6192 Contra Costa	Arbon Path	250	6	B	P	111	Y	C	2	0	2	N	Y	M	M	OK	3
144	6190 Buena Vista	6190 Broadway Terrace	Arbon Path	290	6	B	R	67	Y	C	2	0	4	N	Y	M	M	OK	3
169	485 Clifton St	Cavour St at Redondo		400	6	B	P	0	N	A	0	0	10	N	N	N	M	OK	3
171	109 Monte Vista	72 Montel		270	4	B	P	0	Y	A	0	0	2	N	Y	M	M	OK	3
192	Calmar at Mandana	704 Longridge		250	5	B	P	96	N	AC	0	0	4	N	Y	M	M	OK	3
198	4900 Harbord	72 Sonia		200	3	B	P	18	N	CDB	0	0	4	Y	N	M	M	OK	3

CITYWIDE INVENTORY OF STAIRS AND PATHS

ATTACHMENT D

Walkway #	From	To	Name	Length	Width	Public/Private (B/P)	Passable/Impassable (P/I)	Stairs (Y/N/#)	Hand rail (Y/N)	Materials (concrete, asphalt, dirt, wood, gravel)	Signs (#)	Light (Y/N/#)	Residences or Buildings (#)	Near School (Y/N)	Near Transit (Y/N)	Slope (none, moderate, steep)	Plants (light, moderate, heavy)	Condition (good, OK, bad)	Total
202	801 Santa Ray	800 Mandana		200	5	B	P	6	N	C	0	0	4	N	Y	M	M	OK	3
203	700 Mandana	689 Santa Ray		200	5	B	P	16	N	AWD	0	0	4	N	Y	M	M	OK	3
204	1085 Brookwood	850 Alma		250	5	B	P	148	Y	AW	0	0	4	N	Y	S	L	OK	3
206	796 Rosemount	801 Longridge		200	6	B	P	27	N	C	0	0	4	N	Y	M	M	OK	3
220	Croxton & Richmond	3084 Richmond		100	6	B	P	Y	Y	C	0	0	20	N	N	M	L	OK	3
239	Castro St.	13th at Preservation Park Way		50	5	V	P	0	N	C	0	0	3	N	Y	N	L	G	3
2	6947 Colton	2 Lodge Ct.		110	5	B	P	0	N	A	0	0	2	N	Y	N	M	G	2
24	7695 Crest	7640 Sunkist		250	10	B	I	0	N	D	0	0	4	N	N	S	M	B	2
26	7852 Outlook	7852 Hillmont	Cumberland Way	250	8	B	I	0	N	D	1	0	4	N	N	M	M	B	2
34	4415 Masterson	4412 MacArthur	Madrone Path	200	5	B	P	0	N	C	2	0	4	N	Y	N	L	G	2
36	4500 Steele	4451 Worden		175	5	B	P	0	N	C	0	0	4	Y	N	M	L	G	2
40	2215 41st	2201 Rosedale		200	5	B	P	0	N	C	0	0	4	Y	N	M	M	G	2
47	4326 Arden Pl.	4341 Bridgeview	Bridgeview Path	200	5	B	P	36	Y	C	1	0	4	N	Y	S	L	G	2
49	4645 Park Blvd.	4658 Edgewood Ave.	Elsinore Walk	175	4.5	B	P	0	N	C	2	0	4	N	Y	N	L	G	2
53	1586 Trestle Glen	4 Bowles		250	4	B	P	97	N	CAW	0	0	4	N	N	S	H	B	2
54	5 Bowles	2 Van Sicklen Pl.		150	4	B	P	31	N	AW	0	0	4	N	N	S	H	B	2
57	805 Calmar	800 Santa Ray		300	5.5	B	P	141	N	C	0	0	4	N	N	S	M	G	2
58	4117 Balfour	786 Calmar		250	6	B	P	63	N	C	0	0	4	N	N	S	H	B	2
60	3879 Balfour	647 Wala Vista		250	6	B	P	75	N	C	0	2	4	N	Y	M	M	G	2
65	2441 Castello	2543 Pleasant		100	5	B	P	0	N	C	0	0	2	N	Y	N	H	G	2
70	4079 Lakeshore		Portsmouth Walk	200	5	B	P	8	N	C	2	0	5	N	Y	M	M	G	2
72	853 Walker	3560 Grand	Davidson Way	200	7	B	P	60	Y	C	1	Y	4	N	Y	M	L	G	2
75	3800 Harrison	601 Oakland		300	5	B	P	9	Y	C	1	0	50	N	N	N	M	G	2
76	602 El Dorado	Harrison St.	Oscar's Alley	250	5	B	P	0	N	C	1	0	75	N	N	M	M	G	2
89	5000 Acacia	5918 Margarido	Quail Lane	200	6	B	P	42	Y	C	1	0	4	N	Y	M	H	G	2
93	6188 Oceanview	6394 Brookside	Brookside Lane	180	6	B	P	63	Y	C	2	0	3	Y	N	M	M	G	2
95	6196 Mathieu	6190 Acacia	Verona Path	115	6	B	P	21	Y	C	2	0	3	N	Y	M	M	G	2
96	5850 Romany	59 Yorkshire Dr.	Andeer Path	210	5	B	P	43	Y	CA	2	Y	2	N	Y	M	M	G	2
98	516 52nd St.	517 53rd St.		200	6	B	P	0	N	C	0	1	5	N	Y	N	L	G	2
103	2315 17th Ave	2342 14th Ave	Comstock Way	200	6	B	P	52	Y	C	2	1	6	N	Y	M	M	OK	2
104	2300 14th Ave.	2301 17th Ave.		250	6	B	P	90	Y	C	0	1	10	N	Y	S	L	G	2
114	627 Beacon St.	569 Merritt Ave.		150	8	B	P	Y	Y	C	0	0	13	N	N	S	M	G	2
118	309 Oakland Ave	3020 Harrison	Frisbie Way	175	5	B	P	14	Y	C	1	2	4	N	Y	M	L	G	2
119	243 Orange	264 Oakland Ave.	Perkins Way	150	10	B	P	17	Y	C	1	2	4	N	Y	N	M	G	2
123	5500 Doncaster	6086 Valley View	Merriewood Stairs	250	5	B	P	168	Y	WG	0	0	3	N	Y	S	L	G	2
125	6086 Valley View	5921 Merriewood	Merriewood Stairs	150	5	B	P	122	Y	W	0	1	4	N	Y	M	N	G	2
135	1 Evergreen Ln	50 Alvarado Pl	Evergreen Path	400	5	B	P	128	Y	CA	2	0	3	N	N	S	L	G	2
138	5859 Buena Vista	5501 Golden Gate	Gondo Path	75	5	B	P	31	Y	C	1	0	2	Y	N	S	L	G	2
159	Palmer Ave (dead end)	1647 E 33rd St		50	5	B	P	17	N	C	0	Y	6	N	Y	M	L	G	2

CITYWIDE INVENTORY OF STAIRS AND PATHS

ATTACHMENT D

Walkway #	From	To	Name	Length	Width	Public/Private (B/P)	Passable/Impassable (P/I)	Stairs (Y/N/#)	Hand rail (Y/N)	Materials (concrete, asphalt, dirt, wood, gravel)	Signs (#)	Light (Y/N/#)	Residences or Buildings (#)	Near School (Y/N)	Near Transit (Y/N)	Slope (none, moderate, steep)	Plants (light, moderate, heavy)	Condition (good, OK, bad)	Total
163	Frank Ogawa Plaza	Broadway	Kahn Alley	175	35	B	P	0	N	C	0	Y	0	N	Y	N	L	G	2
167	Hudson St at freeway	482 Hardy St		150	6	B	P	0	N	A	0	0	1	N	Y	N	M	G	2
170	2020 Panama Ct.	109 Monte Vista		150	6	B	P	0	N	C	0	0	4	N	Y	M	M	G	2
214	Leimert @ Monterey	Joaquin Miller Ct. 6 @ Mountain	Diamond Canyon Trail	170	8	B	N	0	N	C	1	0	0	N	Y	N	L	G	2
221	3084 Richmond	3287 Kempton		250	6	B	P	159	Y	C	0	Y	20	N	N	M	M	OK	2
223	78 Rio Vista	645 Fairmount		175	2x5'	B	P	Y	Y	C	0	0	7	N	N	S	M	OK	2
225	1568 Madison	1547 Lakeside		300	4	P	P	0	N	C	0	6	80	N	Y	M	L	G	2
226	81 Alvarado	681 Alvarado	Eucalyptus Path	400	5	B	P	139	Y	CA	2	3	10	N	N	S	M	G	2
228	6101 Thornhill	5500 Doncaster	Merriewood Stairs	200	5	B	P	98	Y	WG	0	0	3	N	Y	S	L	G	2
231	717 Longridge	707 Rosemount		50	5	B	P	7	N	CG	0	0	1	N	Y	M	M	G	2
234	LaSalle (dead end)	Medau (dead end)		150	4	B	P	0	N	C	0	0	1	N	Y	N	L	G	2
235	Cortereal (dead end)	walkway 2052		100	3	B	P	0	N	C	0	0	1	N	Y	N	L	G	2
237	Clay St.	Jefferson St.		250	20	V	P	8	Y	SB	0	Y	1	N	Y	N	L	G	2
238	Jefferson St.	MLK Jr Way		250	25	B	P	0	N	C	0	Y	1	N	Y	N	L	G	2
240	21st St	walkway 2059		200	30	V	P	8	Y	SB	0	0	1	N	Y	M	L	G	2
241	walkway 2058	Grand Ave		150	15	V	P	12	Y	C	0	0	1	N	Y	M	L	G	2
242	walkway 2058	Kaiser Plaza		150	15	V	P	0	N	C	0	0	2	N	Y	N	L	G	2
243	Grand at Valdez	21st at Kaiser Plaza		150	15	V	P	0	N	C	0	Y	2	N	Y	N	L	G	2
245	Clay St	Jeferson St		250	25	V	P	0	N	C	0	Y	1	N	Y	N	L	G	2
247	Oak St	Madison St		250	10	V	P	0	N	C	0	Y	1	N	Y	N	L	G	2
248	Madison St	Jackson St		250	10	V	P	0	N	C	0	Y	1	N	Y	N	L	G	2
249	Jackson St	Alice St		250	10	V	P	0	N	C	0	Y	2	N	Y	N	L	G	2
250	Alice St	Harrison St		250	10	V	P	0	N	C	0	Y	0	N	Y	N	L	G	2
251	Harrison St	Webster St		250	6	V	P	0	N	C	0	Y	3	N	Y	N	L	G	2
252	Alice at 2nd St	Amtrak Station		200	60	V	P	0	N	B	0	Y	1	N	Y	N	L	G	2
265	3300 Paxton Ave	3433 Paxton Ave		350	6	B	P	39	Y	CAW	0	2	4	N	N	M	L	G	2
266	2460 34th Ave	2537 34th Ave		225	9	B	P	0	N	C	0	2	10	N	N	N	L	G	2
32	3226 Herriott	4511 Camden		150	4	B	P	0	N	A	0	0	3	N	N	S	L	OK	1
55	920 Carlston	839 Portal		250	2.5	B	P	0	N	CA	0	1	4	N	N	M	H	OK	1
77	4200 Entrada	4215 Glen		130	5	B	P	0	N	C	0	0	3	N	N	N	L	OK	1
80	4463 Moraga	4486 Pleasant Valley Ct. S.		230	8	B	P	17	Y	C	0	0	1	N	N	N	L	OK	1
82	6098 Rockridge Blvd. N.	6001 Ocean View	Ridgeview Path	250	6	B	P	47	Y	C	1	0	0	N	N	M	M	OK	1
83	6041 Margarido	6135 Rockridge Blve. N.		170	6	B	P	72	N	C	0	0	4	N	N	M	M	OK	1
92	6247 Acacia	245 Cross Rd.	Locarno Path	220	8	B	P	88	N	C	1	0	4	N	N	M	M	OK	1
166	169 Alvarado	277 Alvarado	Willow Walk	300	5	B	P	77	Y	CSA	2	0	4	N	N	S	L	OK	1
205	906 Hillcroft	924 Larkspur Rd		175	5	B	P	58	N	CWA	0	0	4	N	N	S	M	OK	1
222	1733 Broadway	1720 Telegraph		125	10	B	P	0	N	C	0	Y	0	N	Y	N	L	G	1
232	1 Clarewood Mall	7 Clarewood Mall	Clarewood Mall	150	5	V	P	2	N	C	3	3	8	N	N	N	M	G	1
35	4400 Pampas	3811 Madrone		100	5	B	P	11	N	C	0	0	3	N	N	M	L	G	0

CITYWIDE INVENTORY OF STAIRS AND PATHS

ATTACHMENT D

Walkway #	From	To	Name	Length	Width	Public/Private (B/P)	Passable/Impassable (P/I)	Stairs (Y/N/#)	Hand rail (Y/N)	Materials (concrete, asphalt, dirt, wood, gravel)	Signs (#)	Light (Y/N/#)	Residences or Buildings (#)	Near School (Y/N)	Near Transit (Y/N)	Slope (none, moderate, steep)	Plants (light, moderate, heavy)	Condition (good, OK, bad)	Total
43	3136 Madeline	3111 California		250	6	B	P	0	N	C	0	0	4	N	N	M	M	G	0
50	4630 San Sebastian	4639 Edgewood Ave.		200	4.5	B	P	12	Y	C	0	0	4	N	N	M	L	G	0
59	4117 Balfour	713 Waia Vista		250	6	B	P	104	N	C	0	0	4	N	N	S	H	G	0
71	853 Walker	847 Vermont	Davidson Way	250	8	B	P	146	N	C	1	Y	20	N	Y	M	M	OK	0
91	101 Alpine Terrace	6247 Acacia	Locamo Path	160	10	B	P	62	N	C	2	0	0	N	N	M	M	OK	0
94	200 Cross	6196 Mathieu	Verona Path	150	6	B	P	52	Y	C	1	0	0	N	N	M	M	G	0
129	6150 Pinewood	6106 Fairlane Dr.		150	4	B	P	62	Y	C	0	0	2	N	N	M	L	G	0
201	903 Wawona	939 Portal		150	5	B	P	77	Y	C	0	0	3	N	N	M	M	G	0
217	1011 Hubert	982 Grosvenor		200	4	B	P	9	N	A	0	0	6	N	N	M	M	G	0
224	4305 Harbor View	4069 Huntington		175	5	B	P	0	N	D	0	0	4	N	N	M	L	G	0
254	1103 Embarcadero E	Bay Trail		150	10	B	P	0	N	C	1	Y	2	N	N	N	L	G	0
255	1103 Embarcadero E	Bay Trail		150	10	V	P	0	N	C	1	Y	1	N	N	N	L	G	0
256	1755 Embarcadero E	Bay Trail		150	10	B	P	0	N	C	1	2	2	N	N	N	L	G	0
257	E 7th at 29th Ave	E 7th at 29th Ave		100	6	B	P	0	N	C	4	0	0	N	N	N	L	OK	0
147	5891 Morpeth / 190 Modoc	4905 Proctor		175	5	B	P	83	N	C	0	0	3	N	N	M	M	G	0
264	Edgewater at Hassler Way	Bay Trail		0															
272	Joaquin Miller @ Highway 13	Burdeck Ct		0															

OFFICE OF THE CITY CLERK
CITY OF OAKLAND

2007 MAR -1 PM 6:18

Approved as to Form And Legality:

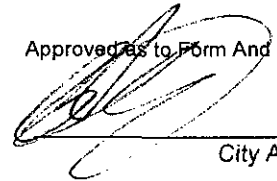

City Attorney

OAKLAND CITY COUNCIL

RESOLUTION NO. _____ C.M.S.

Introduced by Councilmember _____

RESOLUTION AUTHORIZING AWARD OF A CONTRACT TO BAY CONSTRUCTION FOR THE REHABILITATION OF TRESTLE GLEN STAIRS (PROJECT NO. C214810) FOR AN AMOUNT NOT TO EXCEED THREE HUNDRED FIFTY-THREE THOUSAND NINE HUNDRED EIGHTY DOLLARS (\$353,980.00)

WHEREAS, the project consisting of construction of timber and concrete stairs, handrails, new concrete pathway and sidewalk, fences, concrete and stone walls will improve the deteriorating pedestrian pathways and accessibility, and connect these restored stairs to a network of stairs and paths leading to mass transit; and

WHEREAS, the project will reduce blight, improve and upgrade the pedestrian amenities and pedestrian safety, and meet the Federal Americans with Disabilities Act requirements; and

WHEREAS, on September 29, 2006, advertisement of the projects to solicit bids was placed in the Oakland Tribune and San Francisco Chronicle newspapers, and Notices to Bidders were sent to all contractors holding an "A" License in the City's database and the Daily Pacific Builder; and

WHEREAS, on October 23, 2006, the City Clerk received and opened three bids for these projects. Bay Construction is the responsible low bidder with a bid price of \$353,980.00 and has met the 20% City contract requirements for Local Business Enterprise and Small Local Business Enterprise (LBE/SLBE); and

WHEREAS, there are sufficient funds available in the project budget to cover the project costs including the construction contract ten (10%) percent contingency, design support and construction management costs for the project; and

WHEREAS, the City lacks the equipment and qualified personnel to perform the necessary work; and

WHEREAS, the City has all the existing funding of \$450,000.00 in the Rehabilitation of the Trestle Glen Stairs (Project No. C214820) Fund 2211, needed to complete this project with Alameda County Transportation Improvement Authority (ACTIA) as the source of funding; and

WHEREAS, the City Council finds and determines that the performance of this contract is in the public interest because of economy; and

WHEREAS, the City Council finds that services under this contract will be temporary; and

WHEREAS, the City Council finds and determines that the performance of this contract shall not result in the loss of employment or salary by any person having permanent status in the competitive services; now, therefore, be it

RESOLVED: That the City Administrator is authorized to award a contract to the responsible low bidder, Bay Construction, in accordance with the terms of its bid therefore, for an amount of Three Hundred Fifty-Three Thousand Nine Hundred Eighty Dollars (\$353,980.00); and be it

FURTHER RESOLVED: That the plans and specifications prepared by the Director of Public Works for this project are hereby approved; and be it

FURTHER RESOLVED: That the amount of the bond for faithful performance is one hundred percent (100%) of the bid amount, and the amount for a bond to guarantee payment of all claims for labor and materials furnished and for the amount due under the Unemployment Insurance Act, equal to the bid amount, with respect to such work are hereby approved; and be it

FURTHER RESOLVED: That the contract shall be reviewed and approved by the City Attorney for form and legality and placed on file in the Office of the City Clerk.

IN COUNCIL, OAKLAND, CALIFORNIA, _____, 2007

PASSED BY THE FOLLOWING VOTE:

AYES-BROOKS, BRUNNER, CHANG, KERNIGHAN, NADEL, QUAN, REID, and PRESIDENT DE LA FUENTE

NOES-

ABSENT-

ABSTENTION-

ATTEST: _____
LaTonda Simmons
City Clerk and Clerk of the Council
of the City of Oakland, California