



OAKLAND
PUBLIC LIBRARY
MASTER FACILITIES PLAN

FEASIBILITY STUDY
of the adaptive reuse of the
KAISER ARENA
as a
NEW MAIN LIBRARY



GROUP 4

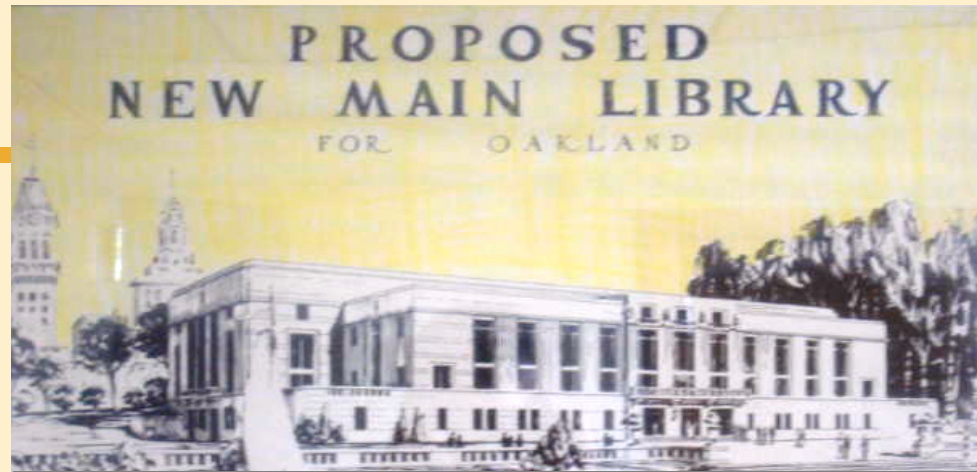

1933 Library Bond Campaign Poster



HJ Kaiser Convention Center Today

Feasibility Study of the adaptive reuse of Kaiser Arena as a new Main Library

City Council Progress Report
7 March 2006



OAKLAND
PUBLIC LIBRARY
MASTER FACILITIES PLAN

FEASIBILITY STUDY
of the adaptive reuse of the
KAISER ARENA
as a
NEW MAIN LIBRARY



GROUP 4

Agenda

- Need for a new Main Library
- Study Purpose
- Main Library as heart of Cultural District
- Arena Conversion Concept
- Technical Issues
- Costs
- Process



OAKLAND
PUBLIC LIBRARY
MASTER FACILITIES PLAN

FEASIBILITY STUDY
of the adaptive reuse of the
KAISER ARENA
as a
NEW MAIN LIBRARY



GROUP 4

Severely Inadequate Main Library

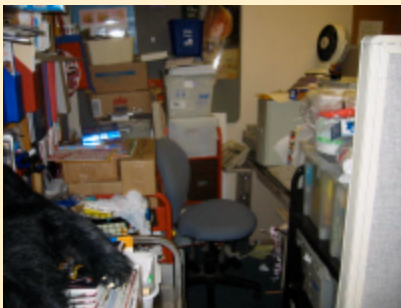

- Severe lack of space for collection, computers, programs, and staff work
- Large portions of collection inaccessible
- Older building does not have capacity or accommodations for new technology
- Inefficient use of space - maze of hallways and rooms
- Lack of needed meeting, tutoring, and study space for community and students
- No significant upgrades since originally built



OAKLAND
PUBLIC LIBRARY
MASTER FACILITIES PLAN

FEASIBILITY STUDY
of the adaptive reuse of the
KAISER ARENA
as a
NEW MAIN LIBRARY



GROUP 4

Kaiser Convention Center





OAKLAND
PUBLIC LIBRARY
MASTER FACILITIES PLAN

FEASIBILITY STUDY
of the adaptive reuse of the
KAISER ARENA
as a
NEW MAIN LIBRARY



GROUP 4

Study Purpose: determine feasibility

- Technical
- Functional
- Historical
- Cost

Team

- Library, PWA, CEDA, RDA
- Oakland Museum, Laney College, OUSD
- Architect: Group 4
- Structural: Rutherford & Chekene
- Cost: M. Lee Corporation
- Historical: Carey & Company
- Mechanical / Sustainability: Rumsey Engineers
- Code: Calvin Wong





OAKLAND
PUBLIC LIBRARY
MASTER FACILITIES PLAN

FEASIBILITY STUDY
of the adaptive reuse of the
KAISER ARENA
as a
NEW MAIN LIBRARY

New Main Library at the Heart of a CULTURAL DISTRICT



Oakland
Public
Library



Henry
Kaiser
Convention
Center

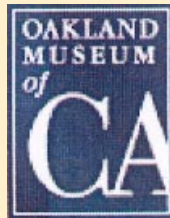

Oakland
Museum



Laney
College



GROUP 4

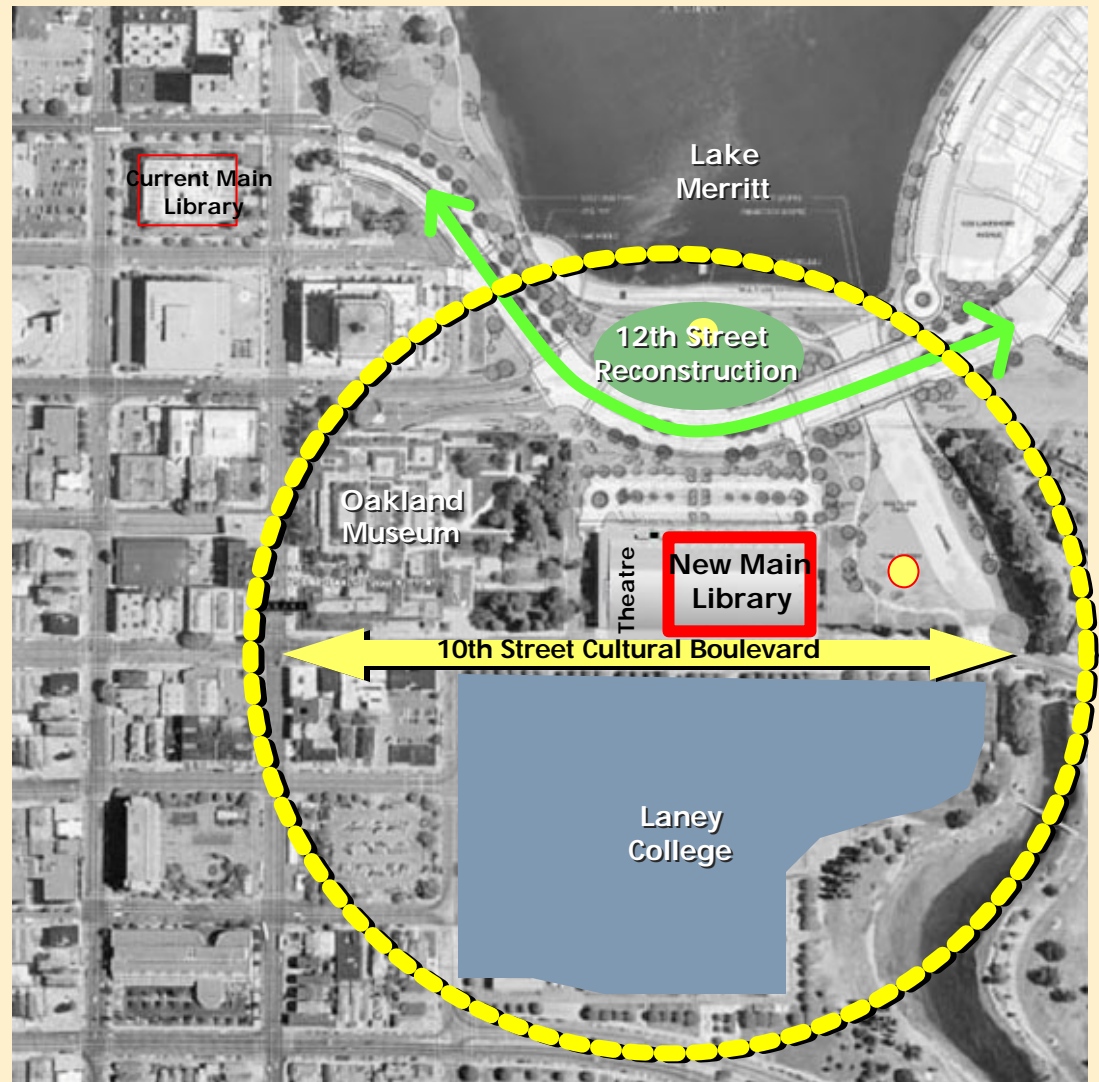



OAKLAND
PUBLIC LIBRARY
MASTER FACILITIES PLAN

FEASIBILITY STUDY
of the adaptive reuse of the
KAISER ARENA
as a
NEW MAIN LIBRARY

Arena Side - convert to library



Issues:

- conversion to new use triggers upgrades
- significant structural upgrades required
- all building systems must be upgraded



GROUP 4



OAKLAND
PUBLIC LIBRARY
MASTER FACILITIES PLAN

FEASIBILITY STUDY
of the adaptive reuse of the
KAISER ARENA
as a
NEW MAIN LIBRARY



GROUP 4

New Main Library in former arena



- civic focal point
- exciting destination
- more books & media
- expanded technology
- café
- literacy
- history center
- teen zone
- accessibility resources
- 4-5 levels
- around central atrium
- sustainable design
- efficient to operate
- easy to use



OAKLAND
PUBLIC LIBRARY
MASTER FACILITIES PLAN

FEASIBILITY STUDY
of the adaptive reuse of the
KAISER ARENA
as a
NEW MAIN LIBRARY



GROUP 4

New Main Library Children's Pavilion in Channel Park



- new construction to east side
- views of park and lake
- children's and family center
- storytime
- educational support
- sustainable design

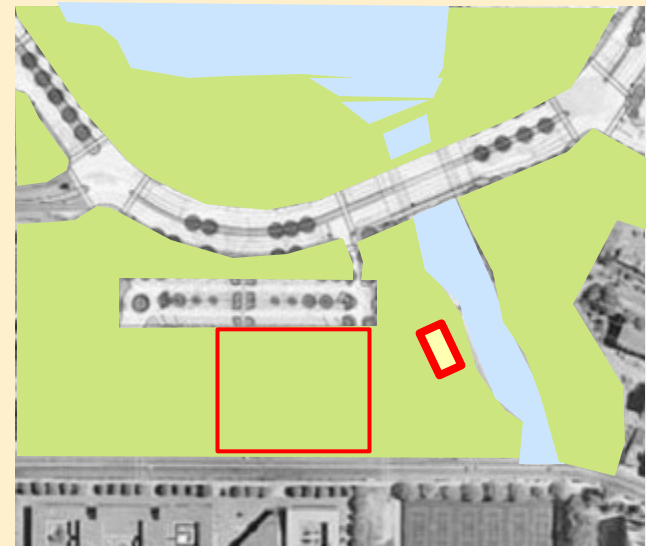



OAKLAND
PUBLIC LIBRARY
MASTER FACILITIES PLAN

FEASIBILITY STUDY
of the adaptive reuse of the
KAISER ARENA
as a
NEW MAIN LIBRARY



GROUP 4

Theater side - minimal work



Issues:

- maintain legal non-conforming uses
- determine adequacy of 1980's upgrades
- finishes, sound system upgrades





OAKLAND
PUBLIC LIBRARY
MASTER FACILITIES PLAN

FEASIBILITY STUDY
of the adaptive reuse of the
KAISER ARENA
as a
NEW MAIN LIBRARY



GROUP 4

New Library Construction - concept

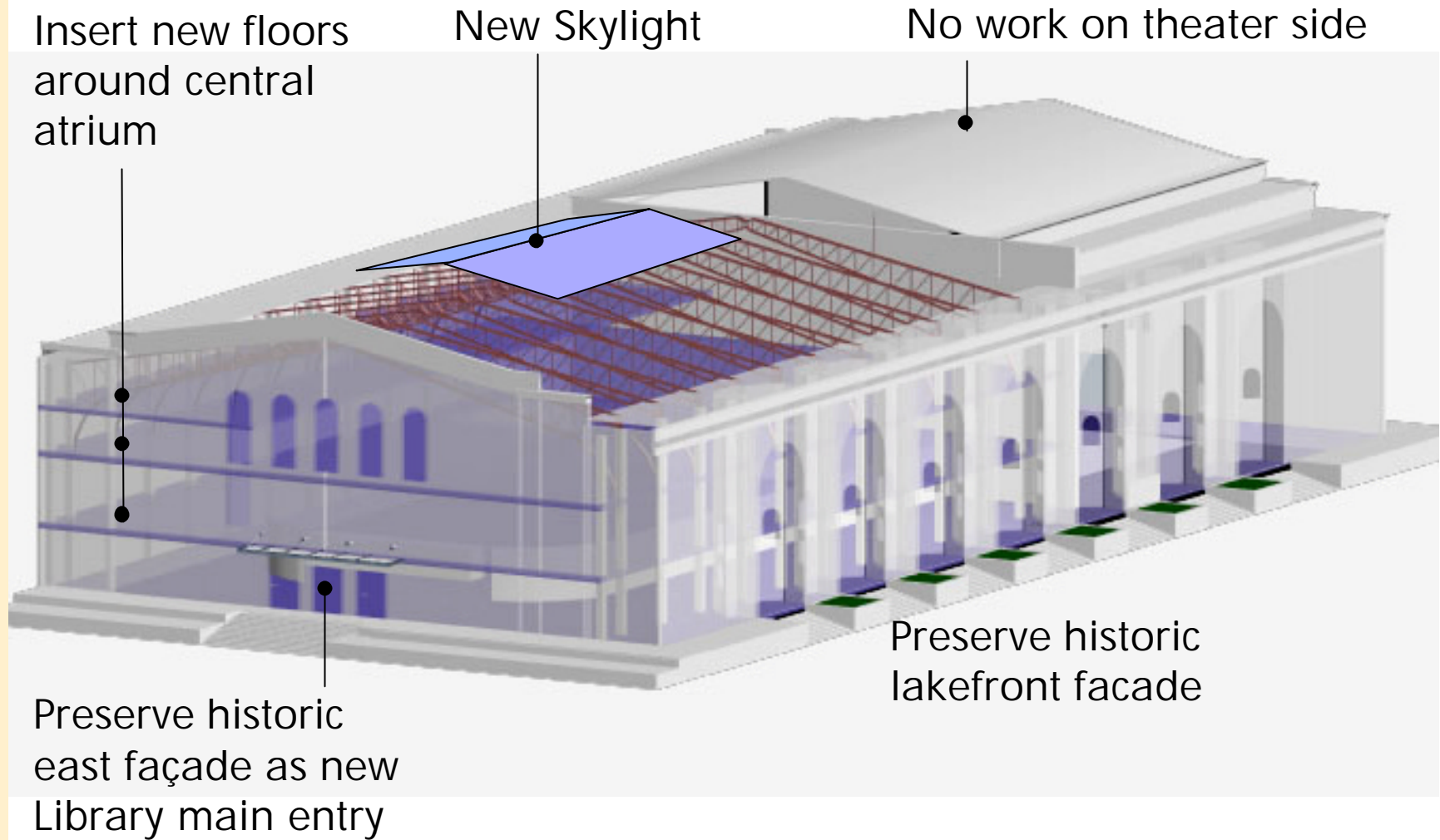



OAKLAND
PUBLIC LIBRARY
MASTER FACILITIES PLAN

FEASIBILITY STUDY
of the adaptive reuse of the
KAISER ARENA
as a
NEW MAIN LIBRARY

New Library Construction - concept

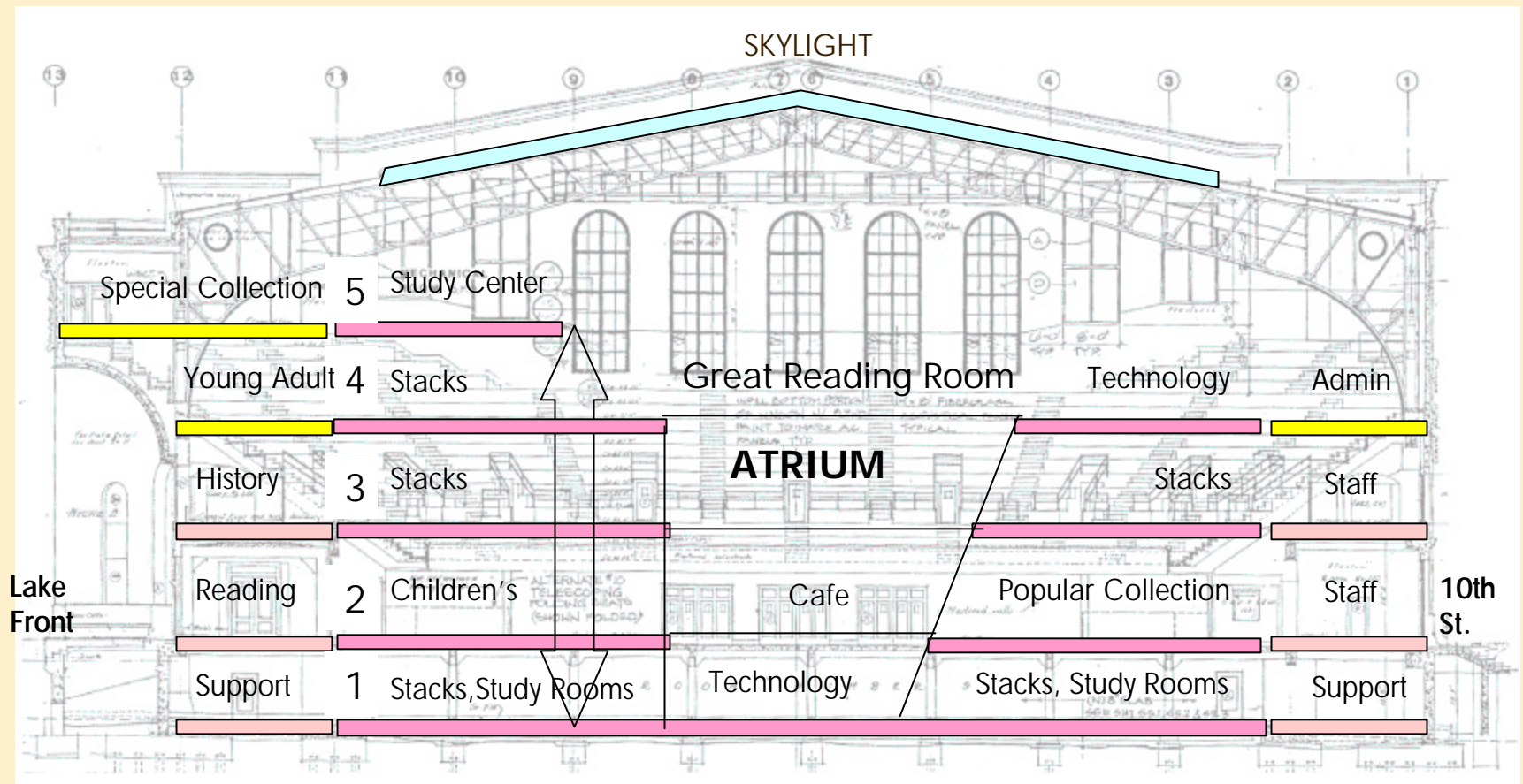

120,000-160,000 square feet
provided on 4-5 levels and possible new exterior pavilion



GROUP 4



OAKLAND
PUBLIC LIBRARY
MASTER FACILITIES PLAN

FEASIBILITY STUDY
of the adaptive reuse of the
KAISER ARENA
as a
NEW MAIN LIBRARY

New Library Construction - preservation

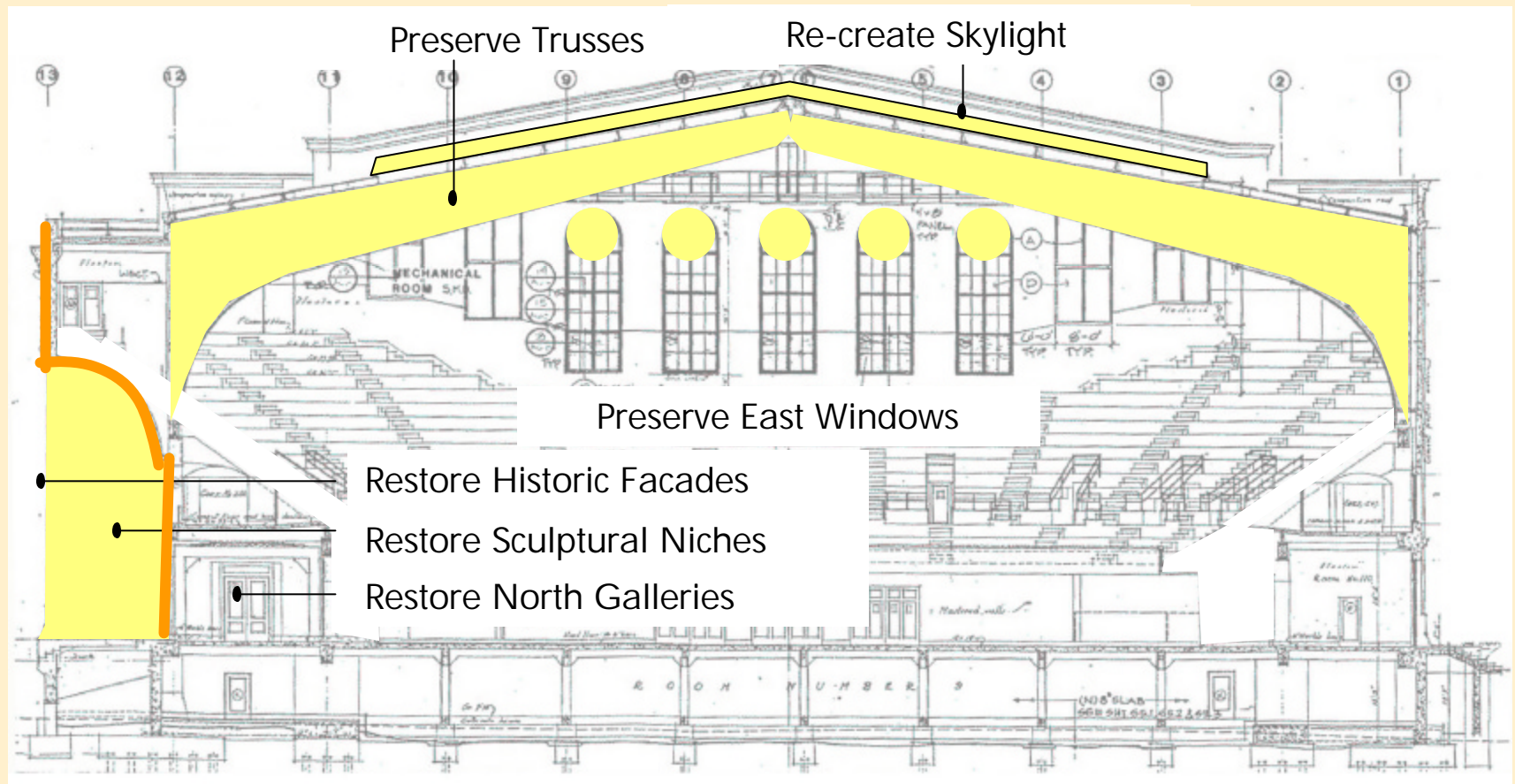

GROUP 4



OAKLAND
PUBLIC LIBRARY
MASTER FACILITIES PLAN

FEASIBILITY STUDY
of the adaptive reuse of the
KAISER ARENA
as a
NEW MAIN LIBRARY

New Library Construction - demolition

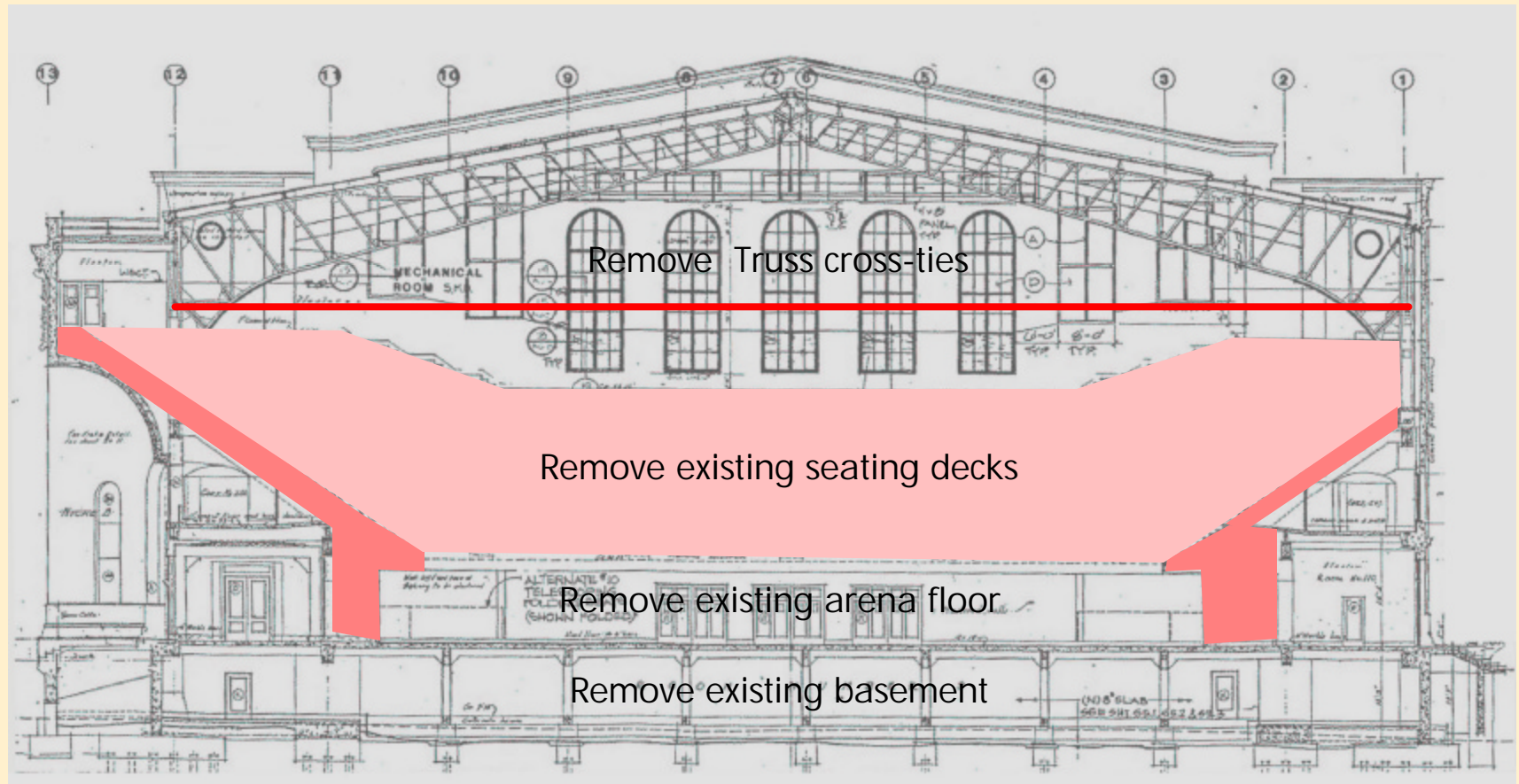

Abandon Existing Central Piles



GROUP 4



OAKLAND
PUBLIC LIBRARY
MASTER FACILITIES PLAN

FEASIBILITY STUDY
of the adaptive reuse of the
KAISER ARENA
as a
NEW MAIN LIBRARY



GROUP 4

New Library Construction - Infill

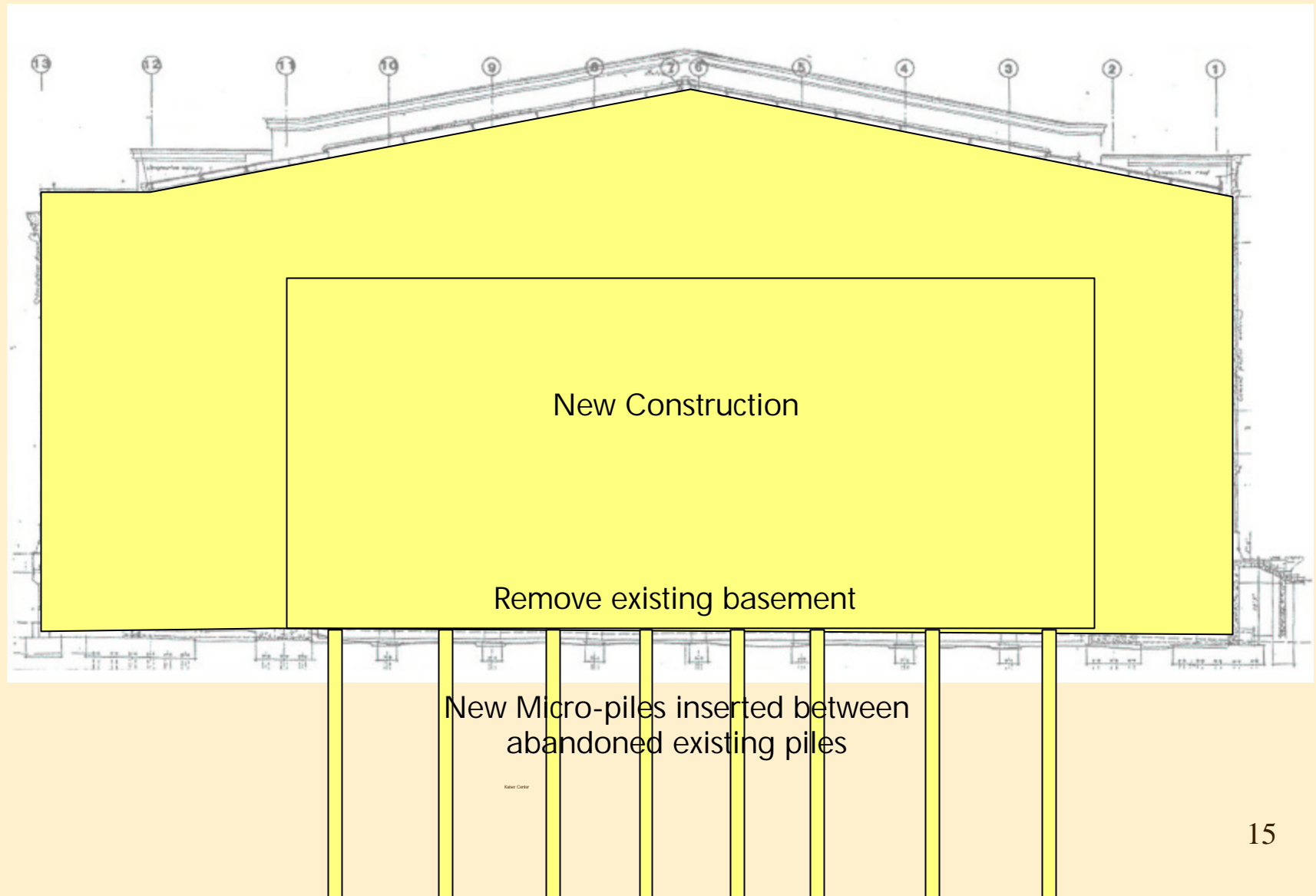



OAKLAND
PUBLIC LIBRARY
MASTER FACILITIES PLAN

FEASIBILITY STUDY
of the adaptive reuse of the
KAISER ARENA
as a
NEW MAIN LIBRARY

Strengthen and
Supplement
Existing Structure

Isolate movement
of new and old



GROUP 4

New Library Construction - structure

New Structure meets current codes, and strengthen existing

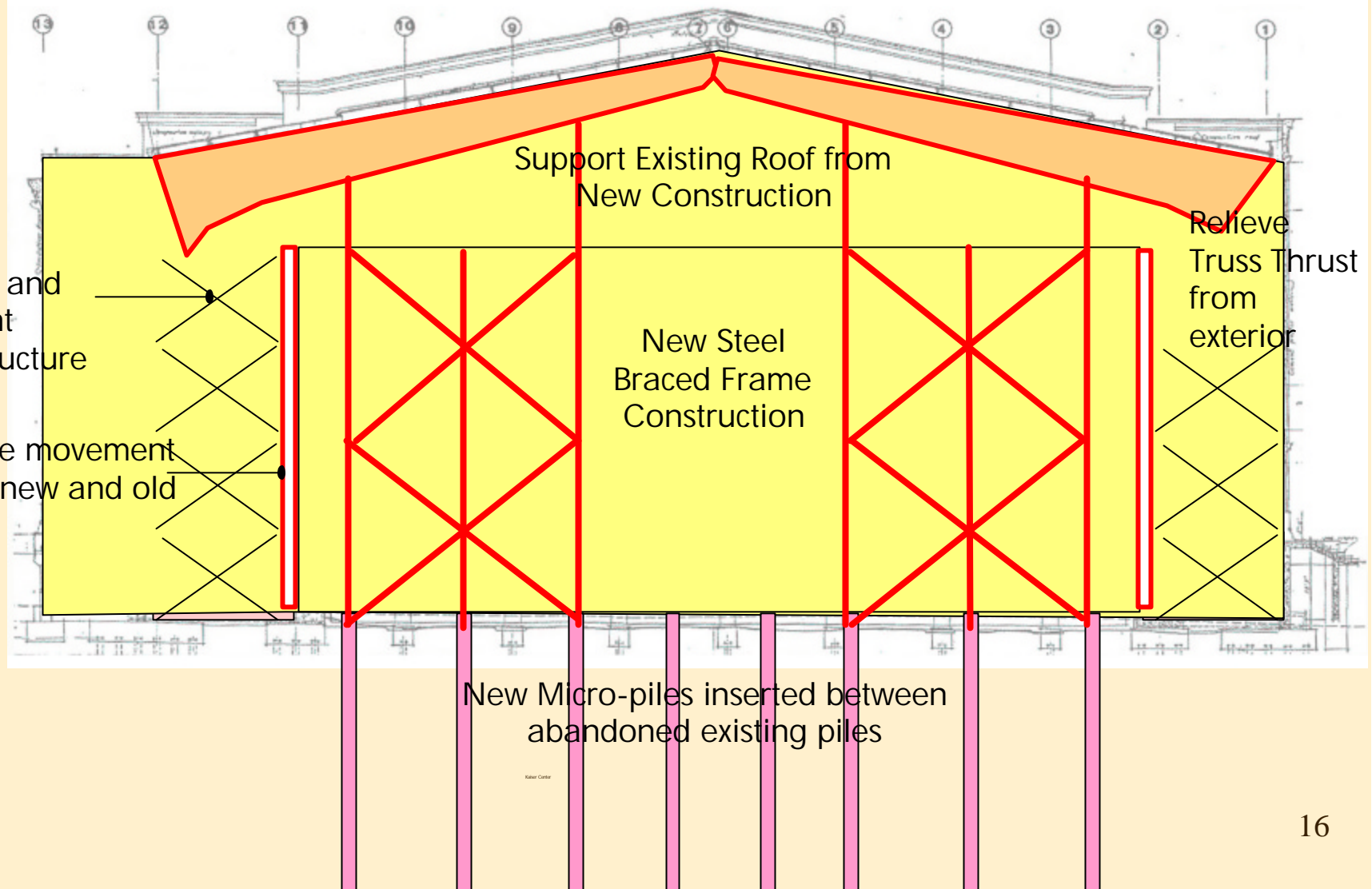



OAKLAND
PUBLIC LIBRARY
MASTER FACILITIES PLAN

FEASIBILITY STUDY
of the adaptive reuse of the
KAISER ARENA
as a
NEW MAIN LIBRARY



GROUP 4

New Library Construction - cost factors

A new main library at the Kaiser Arena is a combination of new library construction inside the Arena, new construction outside the Arena, and rehabilitation of the existing Arena construction:

- **New Construction inside the Arena** \$\$\$
 - Conventional construction costs for new library
 - Premiums for demolition, foundations, construction within existing shell and atrium construction
 - Savings for no new exterior
- **New Construction outside the Arena** \$\$
 - Conventional construction costs for new library
- **Rehabilitation of existing Kaiser Center areas** \$\$
 - Any conversion of arena will carry costs of upgrades
 - Premiums for temporary construction, structural & building system upgrades, and exterior restoration
 - Savings for limited benefit from past structural upgrades



OAKLAND
PUBLIC LIBRARY
MASTER FACILITIES PLAN

FEASIBILITY STUDY
of the adaptive reuse of the
KAISER ARENA
as a
NEW MAIN LIBRARY



GROUP 4

New Library Construction - funding

- State Grants

Up to \$20M from next bond program (June 06 state ballot)

Similar to \$7M grant received for 81st Avenue Branch

- Sale of Existing Main Library

Up to \$15M

County or other buyer - reuse and convert to office, housing or other uses

- Private Fundraising

- New Bond funding

How most Oakland library facilities have traditionally been funded, including current main



OAKLAND
PUBLIC LIBRARY
MASTER FACILITIES PLAN

FEASIBILITY STUDY
of the adaptive reuse of the
KAISER ARENA
as a
NEW MAIN LIBRARY



GROUP 4

Feasibility Study Process - next steps

- Technical

 - Determine Building Systems Strategy

 - Determine Parking Strategy

 - Confirm Code Strategy

 - Develop Cost Model

- Participation

 - City Staff Reviews: planning, building official, other

 - Public Review: Council, Commissions, Community Action Team, other

- Master Facility Plan Implementation - (funding)

 - Phasing strategy

 - Funding Strategy



OAKLAND
PUBLIC LIBRARY
MASTER FACILITIES PLAN

FEASIBILITY STUDY
of the adaptive reuse of the
KAISER ARENA
as a
NEW MAIN LIBRARY

Feasibility Study Process - next steps

- City Wide Master Facility Plan Implementation

Phasing strategy

Funding Strategy

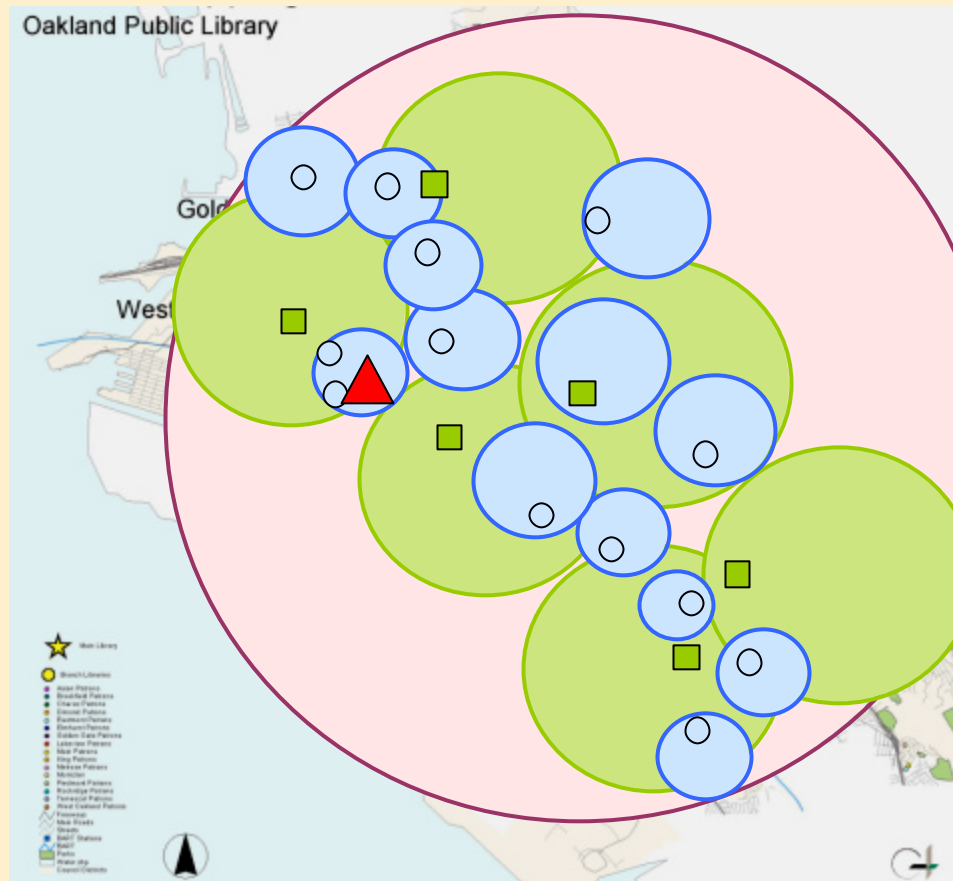

- improve all existing branch facilities to better and more efficiently serve community
- supplement system with new branches to meet unfilled needs
- revitalize main by converting Kaiser Arena



GROUP 4